

SCV-3

SCV-3 is a flangeless wafer type check valve to prevent fluid backflow. It is used widely for steam or water (hot water) piping, etc. and effective in preventing water hammer.

■Features

1. Can be installed between a lot of major flange types and connection standards without measuring device due to the flangeless wafer type.
2. Can be connected in any direction (horizontal or vertical).

■Specifications

Application		Steam, Cold and hot water
Maximum pressure		2.0 MPa
Maximum temperature		5-220°C
Minimum opening pressure		0.003 MPa
Material	Body	Stainless steel
	Disc	Stainless steel
Connection		Wafer *

* A small amount of fluid leaks at the valve seat. So, it should not be used for applications requiring complete closing.

■Dimensions (mm) and Weights (kg)

Nominal size	ϕd	L	ϕD	A	Weight
15A	35.0	16.0	43.0	63.0	0.20
20A	45.0	19.5	53.0	69.5	0.30
25A	51.0	22.0	63.0	80.5	0.40
32A	60.5	28.0	72.5	90.5	0.70
40A	70.0	31.5	82.0	101.0	0.90
50A	90.0	40.0	95.5	115.0	1.50
65A	102.0	45.0	116.0	142.0	2.20
80A	121.0	50.0	129.5	153.5	2.90
100A	145.0	60.0	154.5	180.0	4.50

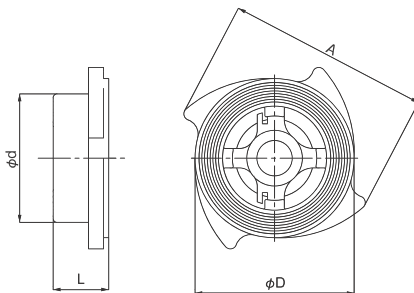

· On installation, align center part of the product with that of flange by making fin-shaped part contact with bolt as indicated in the figure below.

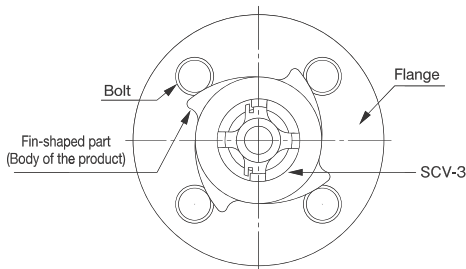

■Pressure Loss Chart (For water)

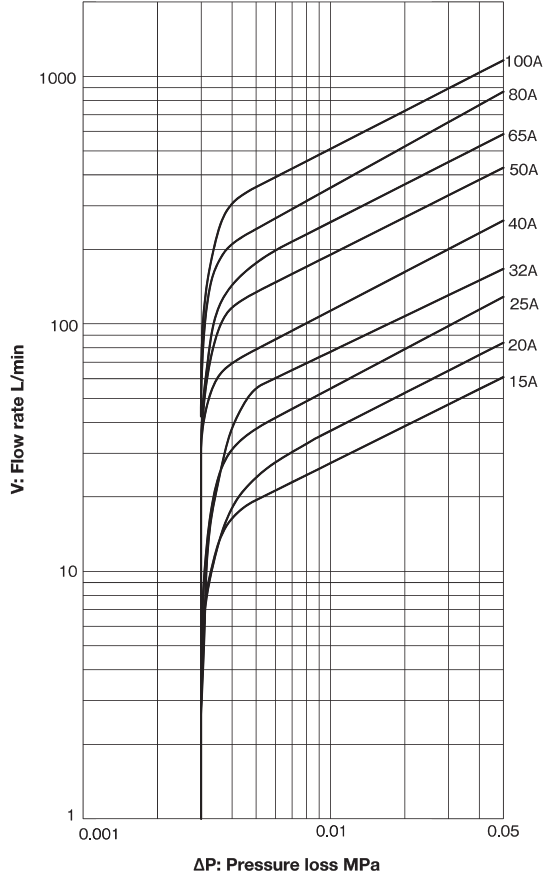

■ Connectable flange standard table

Nominal size	JIS				ASME · JPI				ENPN (GB)				
	5K	10K	16K	20K	125lb	150lb	250lb	300lb	6	10	16	25	40
15A	○	○	○	○	x	○	x	○	○	○	○	○	○
20A	○	○	○	○	x	○	x	○	○	○	○	○	○
25A	○	○	○	○	○	○	○	○	○	○	○	○	○
32A	○	○	○	○	○	○	○	○	○	○	○	○	○
40A	x	○	○	○	○	○	○	○	○	○	○	○	○
50A	x	○	○	○	○	○	○	○	○	○	○	○	○
65A	○	○	○	○	○	○	○	○	○	○	○	○	○
80A	x	○	○	○	○	○	○	○	○	○	○	○	○
100A	x	○	○	○	○	○	○	○	x	○	○	○	○

* "○" means "connectable." "x" means "not connectable."